

- Type:** Compression
- Material:** Stainless Steel
- Protection:** IP 68
- Features:** High Accuracy  
Four Columns Construction
- Application:** Weighbridge Road  
Weighbridge Rail  
Truck & Silo Scales  
Hopper Weigher



**Specifications:**

<b>Capacity</b>	t	10 / 25 / 40 / 60 / 100 / 225 / 450	
<b>Accuracy Class</b>		<b>C3</b>	<b>A5</b>
<b>Max. Number of Verification Intervals</b>	n <sub>max</sub>	3000	5000
<b>Minimum Load cell Verification Interval</b>	V <sub>min</sub>	E <sub>max</sub> /7500	E <sub>max</sub> /15000
<b>Temperature Effect on Zero</b>	%FS/10°C	≤ ± 0.019	≤ ± 0.014
<b>Temperature Effect on Sensitivity</b>	%FS/10°C	≤ ± 0.011	≤ ± 0.013
<b>Combined Error</b>	%FS	≤ ± 0.020	≤ ± 0.026
<b>Creep</b>	%FS	≤ ± 0.016	≤ ± 0.017
<b>Output Sensitivity</b>	mv/v	2.0 ± 0.002	
<b>Input Resistance</b>	Ω	450 ± 4.5	
<b>Output Resistance</b>	Ω	480 ± 5	
<b>Insulation Resistance</b>	MΩ	≥ 5000	
<b>Zero Balance</b>	%FS	1.0	
<b>Temperature, Compensated</b>	°C	-10 ~ +40	
<b>Temperature, Operating</b>	°C	-40 ~ +80	
<b>Excitation, Recommended</b>	v	5 ~ 12(DC)	
<b>Safe Overload</b>	%FS	150	
<b>Ultimate Overload</b>	%FS	300	
<b>Standard Cable Length</b>	m	10 (10t) , 20 (25t ~ 100t)	

**Dimensions:**

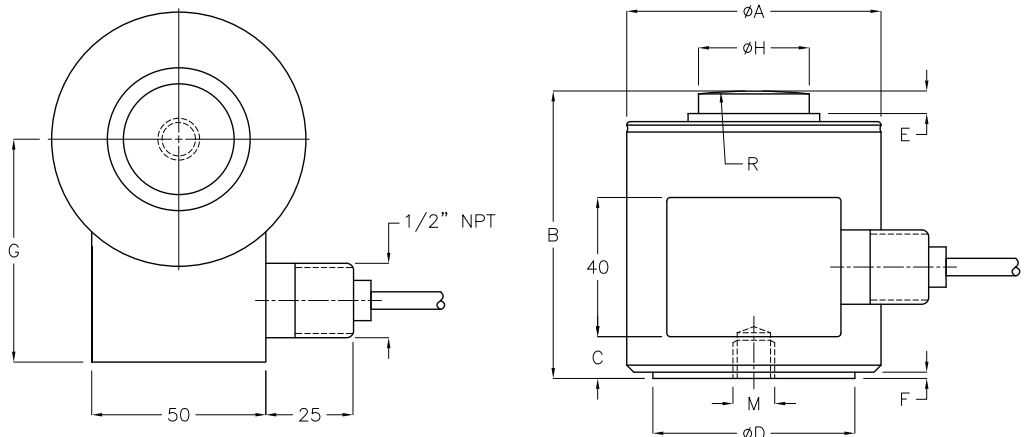
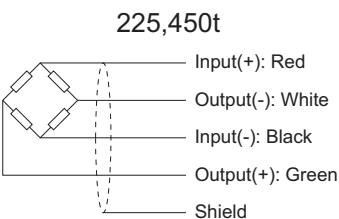
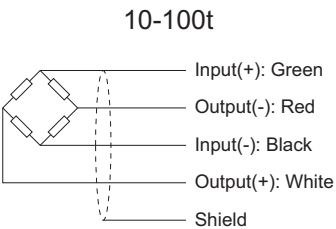

CAP.(t)	A	B	C	D	E	F	G	H	M	R
10,25	73.0	82.5	12.0	58	6.5	1.8	64.0	31.8	M12x1.75(11 Deep)	152.0
40,60	105.0	127.0	34.0	82.5	8.0	11.0	87.0	58.7	M20x2.5(20 Deep)	152.0
100	152.4	184.2	72.3	123.8	23.6	21.8	108.2	79.2	M20x2.5(20 Deep)	432.0
225	164.0	229.0	72.3	148.0	26.0	21.8	108.0	93.7	M20x1.5(25 Deep)	400.0
450	177.0	304.5	97.0	165.1	26.0	21.8	115.0	139.7	M20x1.5(32 Deep)	1143

All dimensions: mm.